

Hazle
Luzerne

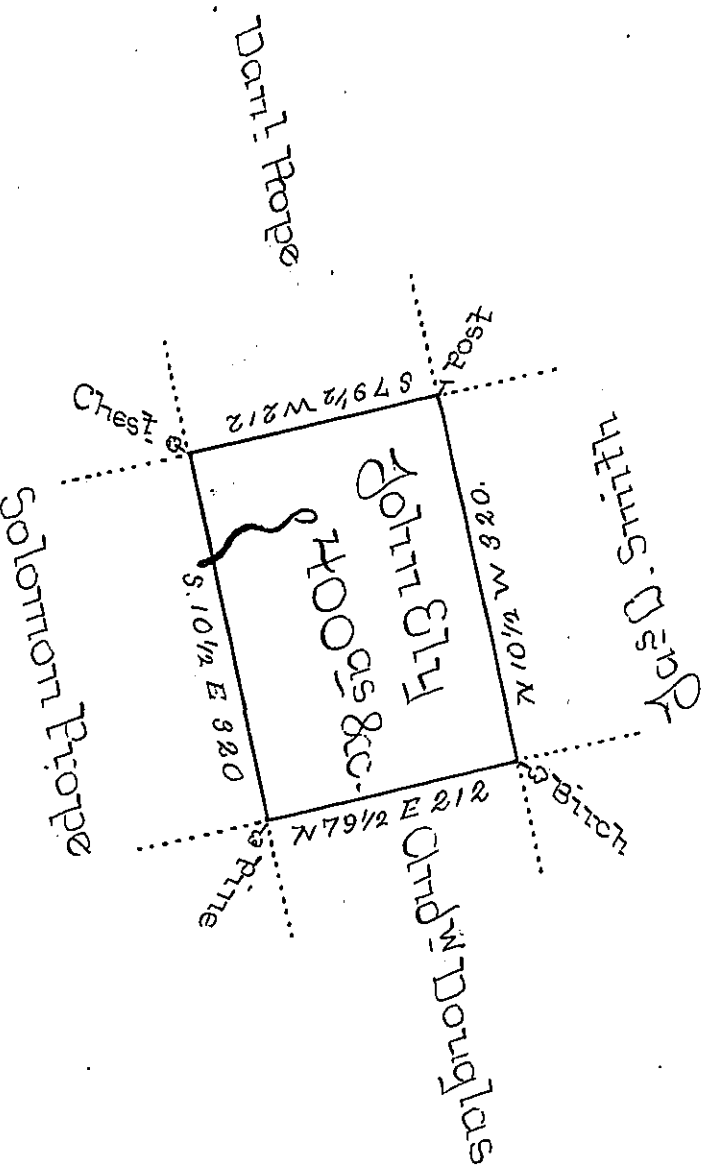

A tract of a tract of Land Called _____ Situate on the
 waters of Black Creek in the County of Northampton
 or Northampton Containing four hundred acres & allowed
 Surveyed for John Ely the 20th of October 1793
 by virtue of a warrant dated the 10th July 1793

To Daniel Brodhead Esq^r }
 Survey Gen^l ~ }

by Wm. Gray obl.

IN TESTIMONY that the above is a copy of the original remaining on file in the
 Department of Internal Affairs of Pennsylvania, made con-
 formably to an Act of Assembly approved the 16th day of
 February, 1833, I have hereunto set my Hand and caused
 the Seal of said Department to be affixed at Harrisburg, this
 second day of November 1897.

James W. Latta
 Secretary of Internal Affairs.